

Automatic Crimp Tester ACT-1000N

- The start button provides smooth flow from Testing to Data saving including OK/NG judgment.
- Save the test conditions up to 26 patterns. The suitable setting is able to be recalled instantly.
- 2 test modes are available "BREAK mode" and "KEEP mode".
- It can partly measure the test in accordance with standards JISC2805 and UL 486A-486B.

Sample setting by One hand

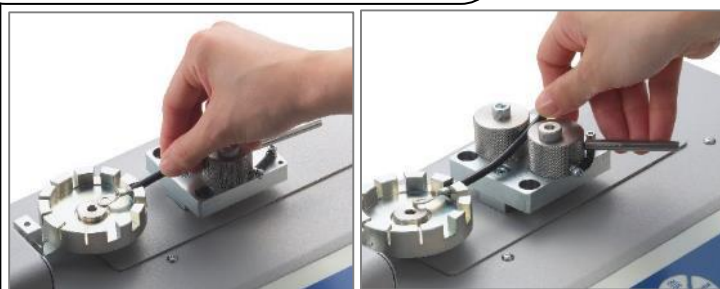

Fixation of terminal

Fixation of wire

Test start by One Button Push



After sample breaking or after loading setting force in setting time, automatically, the moving part is back to the first position.



The one button pressing provides smooth flow from Testing to Data saving.
It reduces the test tasks.

◇ Approved Standard ◇
- JIS C2805(2010)
"Crimp-type terminal lugs for copper conductors"
- UL 486A-486B (2013)
"Standard for Safety for Wire Connectors, 9.3.4 Pullout test"

OK/NG judgement



Result can be judged Pass or Fail according to the setting value.

Data saving in PC or in ACT-1000N



Collective Data Management
- Force
- Date & Time
- OK/NG judgement

USB connecting PC

Store different test conditions along each test sample

Enable to store test conditions up to 26 patterns

Setting Conditions

- Sample name(Alphabet/Number up to 10 letters)
- Test mode (BREAK/KEEP)
- Test Speed
- Judgement Force(OK/NG standard force or Keep force)

| No. | Sample Name | Mode | Speed | Force | Unit | OK/NG |
|-----|-------------|-------|-------|-------|------|-------|
| 1 | SampleA | BREAK | 100 | 100 | N | 1 |
| 2 | SampleB | KEEP | 10 | 50 | N | 1 |
| 3 | SampleC | BREAK | 100 | 100 | N | 1 |
| 4 | SampleD | BREAK | 100 | 100 | N | 1 |
| 5 | SampleE | BREAK | 100 | 100 | N | 1 |
| 6 | SampleF | KEEP | 10 | 50 | N | 1 |
| 7 | SampleG | BREAK | 100 | 100 | N | 1 |
| 8 | SampleH | KEEP | 10 | 50 | N | 1 |
| 9 | SampleI | BREAK | 100 | 100 | N | 1 |
| 10 | SampleJ | BREAK | 100 | 100 | N | 1 |
| 11 | SampleK | KEEP | 10 | 50 | N | 1 |
| 12 | SampleL | BREAK | 100 | 100 | N | 1 |
| 13 | SampleM | KEEP | 10 | 50 | N | 1 |
| 14 | SampleN | BREAK | 100 | 100 | N | 1 |
| 15 | SampleO | BREAK | 100 | 100 | N | 1 |
| 16 | SampleP | BREAK | 100 | 100 | N | 1 |
| 17 | SampleQ | BREAK | 100 | 100 | N | 1 |
| 18 | SampleR | BREAK | 100 | 100 | N | 1 |
| 19 | SampleS | BREAK | 100 | 100 | N | 1 |
| 20 | SampleT | BREAK | 100 | 100 | N | 1 |
| 21 | SampleU | BREAK | 100 | 100 | N | 1 |
| 22 | SampleV | BREAK | 100 | 100 | N | 1 |
| 23 | SampleW | BREAK | 100 | 100 | N | 1 |
| 24 | SampleX | BREAK | 100 | 100 | N | 1 |
| 25 | SampleY | BREAK | 100 | 100 | N | 1 |
| 26 | SampleZ | BREAK | 100 | 100 | N | 1 |

It is possible to edit the conditions on PC by the included software

→The suitable setting can be recalled instantly even if the sample is a lot.

Selectable different test in 2 modes.

1. BREAK mode: Measure force at a crimp terminal breaking.

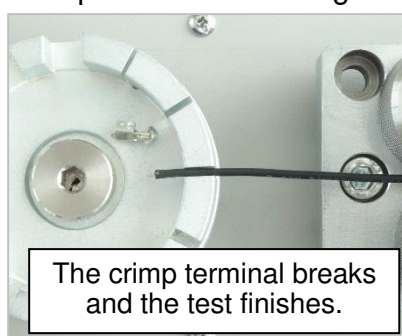
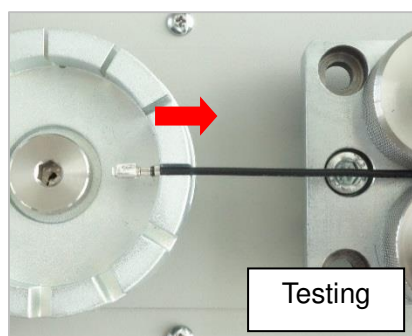

The display shows the peak force at the crimp terminal breaking and the judgment result.



Peak Force Judgement result

2. KEEP mode: Test the tensile durability at setting force

The test in accordance with following standards are possible.

JIS C2805(2010) "Crimp-type terminal lugs for copper conductors." (Keep loading force for 10 sec or more at 25mm/min)

UL 486A-486B(2013) "Standard for Safety for Wire Connectors, 9.3.4 Pullout test" (Keep loading force for 60 sec or more)



Set the test condition at

"Keep loading more than 50N for 10 sec when pulling at 100mm/min".

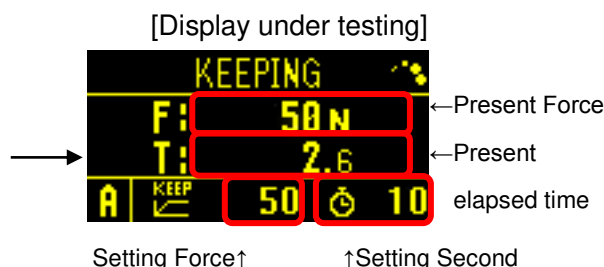
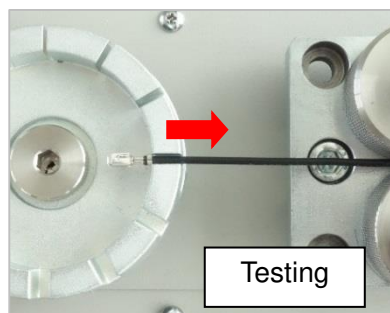

F: Peak Force
T: Loading Time



Judgement result

User-friendly Structure

Discard broken terminals easily by removing the jig from the body.

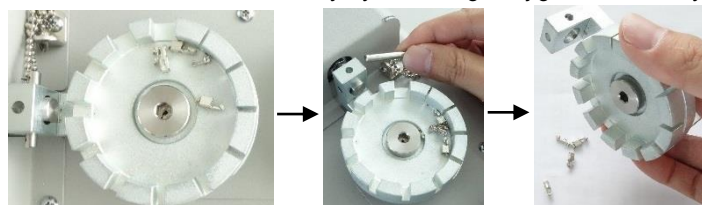

Increase the gripping area and prevent the cover broken.

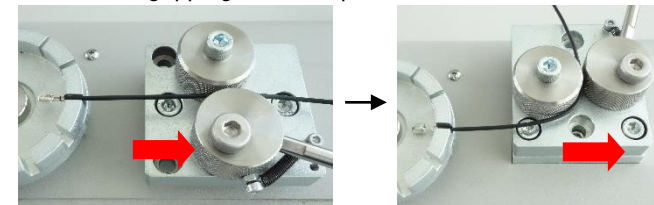

[Included Software]

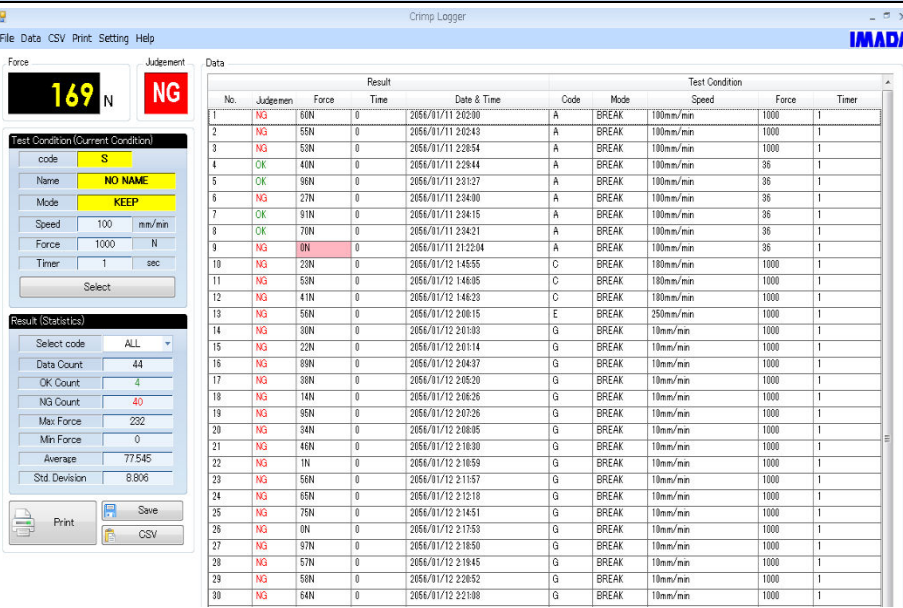
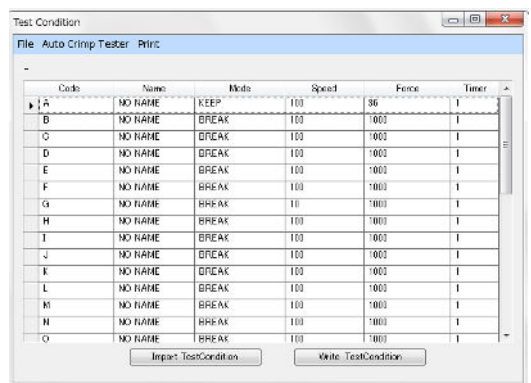
| Test Result Import | Test Condition Edit |
|---|---|
|  |  |
| Save the data (Peak Force, OK/NG judgement, Date&Time, Test condition(Test mode, Speed, Setting force, Setting time) and the statistics can be saved in PC. It is possible to print and CSV output. | Collectively edit the test condition up to 26 patterns (From A to Z)on PC. The edited conditions are available on ACT-1000N. |



[Specification]

| Model | ACT-1000N | ACT-1000N-V300 |
|-------------------------------------|--|--|
| Capacity | 1000N | |
| Resolution | 1N | |
| Accuracy | +/-0.5% F.S +/-1 digit | |
| Unit | N, kgf ,lbf (*1) | |
| Sampling rate | 2000Hz | |
| Safe overload rating | Approx. 150% F.S. | |
| Overload warning | 110% or less | |
| Measuring speed | 10/25/50/100 mm/min (Choose from 4 steps) | 25/50/100/300 mm/min (Choose from 4 step) |
| Stroke | Approx.50mm | |
| Allowable sample diameter | Terminal side: 1~8mm (*2) Harness side: 1~8mm (*2) | |
| Allowable sample length | 100mm or more | |
| Mode | BREAK/KEEP mode | |
| Number of registered test condition | 26 patterns(A~Z) | |
| Output | USB/RS232C/pass or fail decision signal (OK/NG) | |
| Security lock | Emergency stop button and Overload prevention (at the power on) | |
| Power supply | AC100~240V | |
| Weight | Approx.11kg | |
| Size | W400*D240*H150 | |
| Operating environment | Temperature :0~40 degree Celsius Humidity:20~80%RH | |
| Approved standard | -JIS C2805(2010) "Crimp-type terminal lugs for copper conductors." -UL 486A-486B(2013) " Standard for Safety for Wire Connectors, 9.3.4 Pullout test" | |
| Accessory | Software, USB cable, Power cord, Inspection Certificate | |

*1 This is the specifications for International model. Please note the available unit is different from Japanese domestic model and international one

*2 Please contact us when you need to measure smaller size samples. (TEL:+81-(0)532-33-3288)

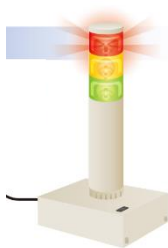

[Related Product]

| Jig for round terminals: ACT-T-01 | Jig for rod terminals: ACT-T-02 | Warning light(Custom-made order) |
|--|--|---|
|  |  |  |
| Easily fix round terminals. The allowable diameter is $\phi 3/5/8$ mm. The user can use the M4 screw hole for inserting a pin. | Grips a small terminal such as a rod terminal which has a same diameter as the wire. | It clearly shows the test judgement result. |
| Dimension: Please refer the dimension | Dimension: Please refer the dimension | - |

[Printer]

| RS232C printer |
|--|
|  <p>Please prepare the printer if necessary. *IMADA RS232C cable CB-208 is available.</p> |
| <p>Direct print is possible by RS232C connecting for the test condition and the results.</p> <p>Operability confirmed device: BL2-58 (Sanei Electric INC.)</p> |

[Other examples of crimp test]

| Simple test by manual tester | General use by vertical motorized test stand | Test for large diameter wire |
|--|---|---|
|  |  |  |
| Configuration DS2-500N / LH-500N | Configuration ZTS-500N / MX2-500N / CB-518 / FW-12 / GP-30 | Configuration ZTS-2500N / MX2-2500N / CB-518 / CH-5000N / CW-5000N |

[Dimension]

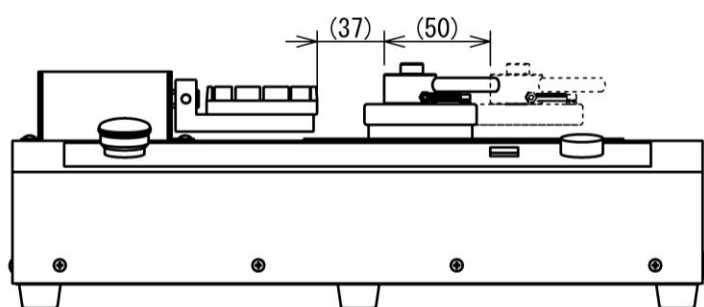
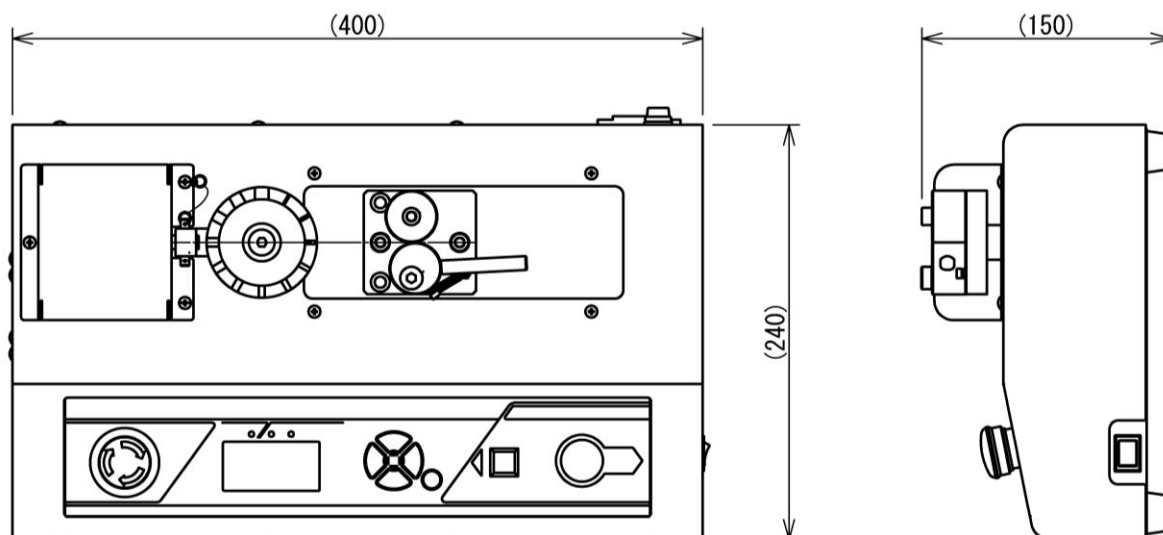

| | |
|--|--------------------------------------|
| Trench dimensions of Wire Terminal Jig | 1,1.5,2,2.5,3,3.5,4,4.5,5,6,7,8 (mm) |
| Allowable diameter of wire clamp jig | 1~8 (mm) |

Please contact us when you need to measure smaller size sample. (TEL:+81-(0)532-33-3288)

Wire Terminal Jig (Included)

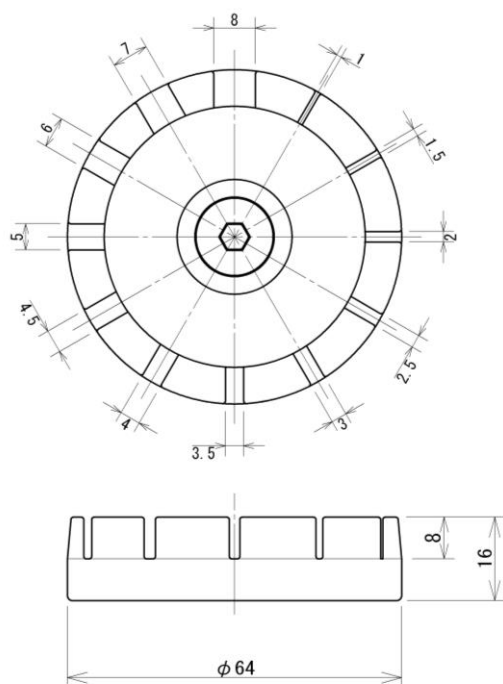

Wire Round Terminal Jig: ACT-T-01(Optional)

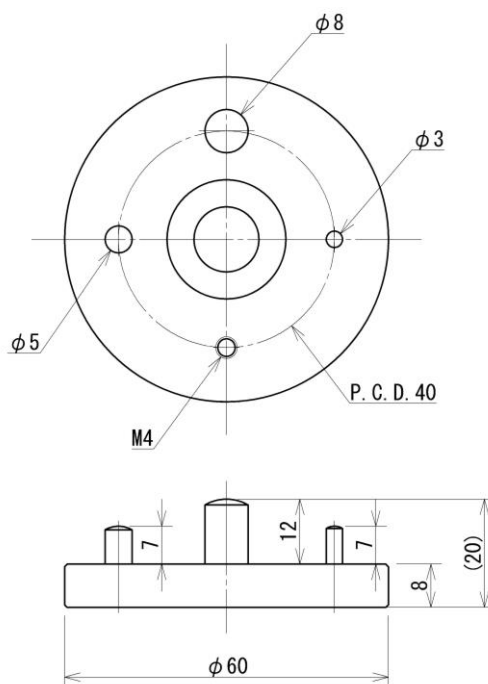

Rod Terminal Jig: ACT-T-02(Optional)

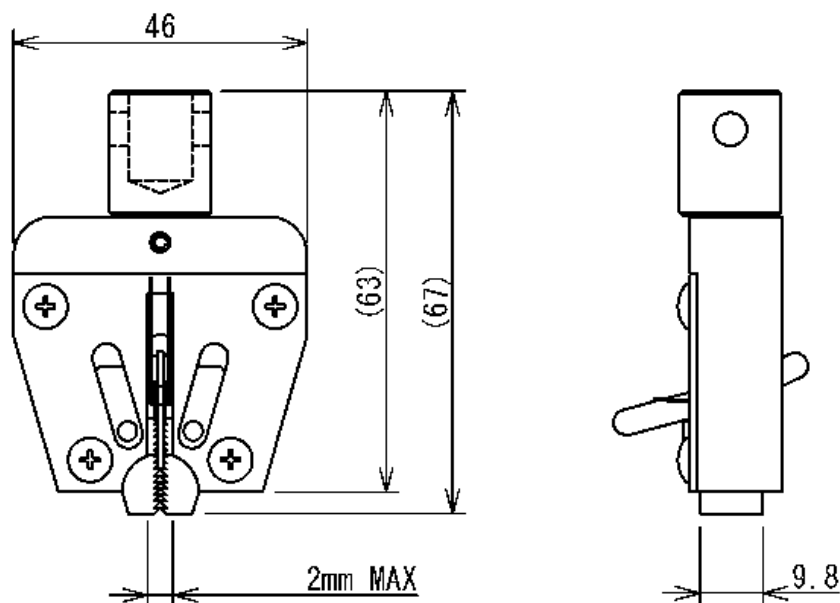

[Caution]

- The contents may be changed without previous notice.
- All of products are designed for measurement purpose only.
- Do not copy and use this content without authority.
- Please note that the capacity is dependent on the displayed unit. Please contact us for details.