

Accessoires pour couplemètre

Technical drawing of a mechanical assembly. The drawing includes a side view of a cylindrical component with a threaded section and a flange. Dimensions are indicated: (163) for the total length, (120) for the distance from the flange to the center of the threaded section, (100) for the distance from the flange to the end of the threaded section, and $\phi 38$ for the diameter of the threaded section. A detail view shows a cross-section of the threaded section with a diameter of $\phi 38$. A separate view shows a spring and a bolt. Dimensions for the spring and bolt are indicated: $\phi 5.5$ for the diameter of the spring, (50) for the length of the spring, and (50) for the length of the bolt. A note indicates the contracted state is 350mm.

Contracted state: 350mm

Dimensions: (163), (120), (100), $\phi 38$, $\phi 5.5$, (50), (50).

Components: 1. Bollet, 2. Ressort, 3. Rondelle, 4. Vis, 5. Rondelle, 6. Vis, 7. Rondelle, 8. Vis, 9. Rondelle, 10. Vis, 11. Rondelle, 12. Vis, 13. Rondelle, 14. Vis, 15. Rondelle, 16. Vis, 17. Rondelle, 18. Vis, 19. Rondelle, 20. Vis, 21. Rondelle, 22. Vis, 23. Rondelle, 24. Vis, 25. Rondelle, 26. Vis, 27. Rondelle, 28. Vis, 29. Rondelle, 30. Vis, 31. Rondelle, 32. Vis, 33. Rondelle, 34. Vis, 35. Rondelle, 36. Vis, 37. Rondelle, 38. Vis, 39. Rondelle, 40. Vis, 41. Rondelle, 42. Vis, 43. Rondelle, 44. Vis, 45. Rondelle, 46. Vis, 47. Rondelle, 48. Vis, 49. Rondelle, 50. Vis, 51. Rondelle, 52. Vis, 53. Rondelle, 54. Vis, 55. Rondelle, 56. Vis, 57. Rondelle, 58. Vis, 59. Rondelle, 60. Vis, 61. Rondelle, 62. Vis, 63. Rondelle, 64. Vis, 65. Rondelle, 66. Vis, 67. Rondelle, 68. Vis, 69. Rondelle, 70. Vis, 71. Rondelle, 72. Vis, 73. Rondelle, 74. Vis, 75. Rondelle, 76. Vis, 77. Rondelle, 78. Vis, 79. Rondelle, 80. Vis, 81. Rondelle, 82. Vis, 83. Rondelle, 84. Vis, 85. Rondelle, 86. Vis, 87. Rondelle, 88. Vis, 89. Rondelle, 90. Vis, 91. Rondelle, 92. Vis, 93. Rondelle, 94. Vis, 95. Rondelle, 96. Vis, 97. Rondelle, 98. Vis, 99. Rondelle, 100. Vis, 101. Rondelle, 102. Vis, 103. Rondelle, 104. Vis, 105. Rondelle, 106. Vis, 107. Rondelle, 108. Vis, 109. Rondelle, 110. Vis, 111. Rondelle, 112. Vis, 113. Rondelle, 114. Vis, 115. Rondelle, 116. Vis, 117. Rondelle, 118. Vis, 119. Rondelle, 120. Vis, 121. Rondelle, 122. Vis, 123. Rondelle, 124. Vis, 125. Rondelle, 126. Vis, 127. Rondelle, 128. Vis, 129. Rondelle, 130. Vis, 131. Rondelle, 132. Vis, 133. Rondelle, 134. Vis, 135. Rondelle, 136. Vis, 137. Rondelle, 138. Vis, 139. Rondelle, 140. Vis, 141. Rondelle, 142. Vis, 143. Rondelle, 144. Vis, 145. Rondelle, 146. Vis, 147. Rondelle, 148. Vis, 149. Rondelle, 150. Vis, 151. Rondelle, 152. Vis, 153. Rondelle, 154. Vis, 155. Rondelle, 156. Vis, 157. Rondelle, 158. Vis, 159. Rondelle, 160. Vis, 161. Rondelle, 162. Vis, 163. Rondelle, 164. Vis, 165. Rondelle, 166. Vis, 167. Rondelle, 168. Vis, 169. Rondelle, 170. Vis, 171. Rondelle, 172. Vis, 173. Rondelle, 174. Vis, 175. Rondelle, 176. Vis, 177. Rondelle, 178. Vis, 179. Rondelle, 180. Vis, 181. Rondelle, 182. Vis, 183. Rondelle, 184. Vis, 185. Rondelle, 186. Vis, 187. Rondelle, 188. Vis, 189. Rondelle, 190. Vis, 191. Rondelle, 192. Vis, 193. Rondelle, 194. Vis, 195. Rondelle, 196. Vis, 197. Rondelle, 198. Vis, 199. Rondelle, 200. Vis, 201. Rondelle, 202. Vis, 203. Rondelle, 204. Vis, 205. Rondelle, 206. Vis, 207. Rondelle, 208. Vis, 209. Rondelle, 210. Vis, 211. Rondelle, 212. Vis, 213. Rondelle, 214. Vis, 215. Rondelle, 216. Vis, 217. Rondelle, 218. Vis, 219. Rondelle, 220. Vis, 221. Rondelle, 222. Vis, 223. Rondelle, 224. Vis, 225. Rondelle, 226. Vis, 227. Rondelle, 228. Vis, 229. Rondelle, 230. Vis, 231. Rondelle, 232. Vis, 233. Rondelle, 234. Vis, 235. Rondelle, 236. Vis, 237. Rondelle, 238. Vis, 239. Rondelle, 240. Vis, 241. Rondelle, 242. Vis, 243. Rondelle, 244. Vis, 245. Rondelle, 246. Vis, 247. Rondelle, 248. Vis, 249. Rondelle, 250. Vis, 251. Rondelle, 252. Vis, 253. Rondelle, 254. Vis, 255. Rondelle, 256. Vis, 257. Rondelle, 258. Vis, 259. Rondelle, 260. Vis, 261. Rondelle, 262. Vis, 263. Rondelle, 264. Vis, 265. Rondelle, 266. Vis, 267. Rondelle, 268. Vis, 269. Rondelle, 270. Vis, 271. Rondelle, 272. Vis, 273. Rondelle, 274. Vis, 275. Rondelle, 276. Vis, 277. Rondelle, 278. Vis, 279. Rondelle, 280. Vis, 281. Rondelle, 282. Vis, 283. Rondelle, 284. Vis, 285. Rondelle, 286. Vis, 287. Rondelle, 288. Vis, 289. Rondelle, 290. Vis, 291. Rondelle, 292. Vis, 293. Rondelle, 294. Vis, 295. Rondelle, 296. Vis, 297. Rondelle, 298. Vis, 299. Rondelle, 300. Vis, 301. Rondelle, 302. Vis, 303. Rondelle, 304. Vis, 305. Rondelle, 306. Vis, 307. Rondelle, 308. Vis, 309. Rondelle, 310. Vis, 311. Rondelle, 312. Vis, 313. Rondelle, 314. Vis, 315. Rondelle, 316. Vis, 317. Rondelle, 318. Vis, 319. Rondelle, 320. Vis, 321. Rondelle, 322. Vis, 323. Rondelle, 324. Vis, 325. Rondelle, 326. Vis, 327. Rondelle, 328. Vis, 329. Rondelle, 330. Vis, 331. Rondelle, 332. Vis, 333. Rondelle, 334. Vis, 335. Rondelle, 336. Vis, 337. Rondelle, 338. Vis, 339. Rondelle, 340. Vis, 341. Rondelle, 342. Vis, 343. Rondelle, 344. Vis, 345. Rondelle, 346. Vis, 347. Rondelle, 348. Vis, 349. Rondelle, 350. Vis, 351. Rondelle, 352. Vis, 353. Rondelle, 354. Vis, 355. Rondelle, 356. Vis, 357. Rondelle, 358. Vis, 359. Rondelle, 360. Vis, 361. Rondelle, 362. Vis, 363. Rondelle, 364. Vis, 365. Rondelle, 366. Vis, 367. Rondelle, 368. Vis, 369. Rondelle, 370. Vis, 371. Rondelle, 372. Vis, 373. Rondelle, 374. Vis, 375. Rondelle, 376. Vis, 377. Rondelle, 378. Vis, 379. Rondelle, 380. Vis, 381. Rondelle, 382. Vis, 383. Rondelle, 384. Vis, 385. Rondelle, 386. Vis, 387. Rondelle, 388. Vis, 389. Rondelle, 390. Vis, 391. Rondelle, 392. Vis, 393. Rondelle, 394. Vis, 395. Rondelle, 396. Vis, 397. Rondelle, 398. Vis, 399. Rondelle, 400. Vis, 401. Rondelle, 402. Vis, 403. Rondelle, 404. Vis, 405. Rondelle, 406. Vis, 407. Rondelle, 408. Vis, 409. Rondelle, 410. Vis, 411. Rondelle, 412. Vis, 413. Rondelle, 414. Vis, 415. Rondelle, 416. Vis, 417. Rondelle, 418. Vis, 419. Rondelle, 420. Vis, 421. Rondelle, 422. Vis, 423. Rondelle, 424. Vis, 425. Rondelle, 426. Vis, 427. Rondelle, 428. Vis, 429. Rondelle, 430. Vis, 431. Rondelle, 432. Vis, 433. Rondelle, 434. Vis, 435. Rondelle, 436. Vis, 437. Rondelle, 438. Vis, 439. Rondelle, 440. Vis, 441. Rondelle, 442. Vis, 443. Rondelle, 444. Vis, 445. Rondelle, 446. Vis, 447. Rondelle, 448. Vis, 449. Rondelle, 450. Vis, 451. Rondelle, 452. Vis, 453. Rondelle, 454. Vis, 455. Rondelle, 456. Vis, 457. Rondelle, 458. Vis, 459. Rondelle, 460. Vis, 461. Rondelle, 462. Vis, 463. Rondelle, 464. Vis, 465. Rondelle, 466. Vis, 467. Rondelle, 468. Vis, 469. Rondelle, 470. Vis, 471. Rondelle, 472. Vis, 473. Rondelle, 474. Vis, 475. Rondelle, 476. Vis, 477. Rondelle, 478. Vis, 479. Rondelle, 480. Vis, 481. Rondelle, 482. Vis, 483. Rondelle, 484. Vis, 485. Rondelle, 486. Vis, 487. Rondelle, 488. Vis, 489. Rondelle, 490. Vis, 491. Rondelle, 492. Vis, 493. Rondelle, 494. Vis, 495. Rondelle, 496. Vis, 497. Rondelle, 498. Vis, 499. Rondelle, 500. Vis, 501. Rondelle, 502. Vis, 503. Rondelle, 504. Vis, 505. Rondelle, 506. Vis, 507. Rondelle, 508. Vis, 509. Rondelle, 510. Vis, 511. Rondelle, 512. Vis, 513. Rondelle, 514. Vis, 515. Rondelle, 516. Vis, 517. Rondelle, 518. Vis, 519. Rondelle, 520. Vis, 521. Rondelle, 522

Technical drawing of a mechanical assembly with dimensions:

- Overall length: 183
- Distance from left end to center of spring: 120
- Distance from left end to center of coil: 100
- Left end diameter: $\phi 38$
- Center of spring diameter: $(\phi 39)$
- Right end diameter: $\phi 24$
- Spring diameter: $\phi 5.5$
- Coil diameter: $\phi 5.5$
- Coil length: 350mm
- Coil state: Contracted state
- Coil to right end distance: 50
- Right end diameter: $\phi 9.4$

SUPRECU
Métrologie - Contrôle industriel

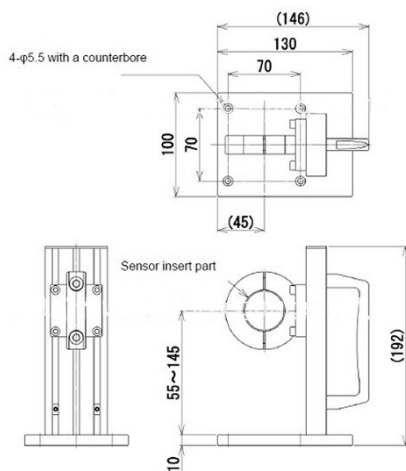

- ✓ 5Nm (500Ncm)
- ✓ Poids : ~1100g
- ✓ Support basculant pour mesures verticales ou horizontales
- ✓ Peut être fixé sur le plan de travail

